

Standard Type Butt-connectors

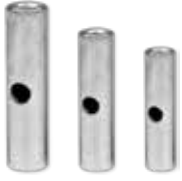

Features

- Tempering of the cable lugs during the production process provides ease of use of the Şafak Cable Lugs and more practical usage
- As the copper is been reheated at 700 degrees, it does not get broken after the crimping process.
- All of the Şafak Cable Lugs and Butt-connectors are being produced by tempering
- ⚠ You must crimp Standard Type Butt-connectors with Standard Type Dies

Material : EN 13600 standard copper
Surface : Tin Plated

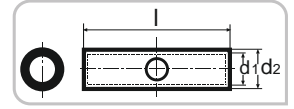

Product Code	Cross-Section mm ²	Dimensions (mm)			Package Amount	Package Weight (-kg)
		d1	d2	L		
EM-6	6 mm²	3,8	5,5	30	800 Pcs	2,30 kg.
EM-10	10 mm²	4,7	6,6	29	600 Pcs	2,50 kg.
EM-16	16 mm²	5,6	7,8	32	400 Pcs	2,50 kg.
EM-25	25 mm²	7,1	9,5	40,5	250 Pcs	2,80 kg.
EM-35	35 mm²	8,2	10,8	45,5	150 Pcs	2,30 kg.
EM-50	50 mm²	10,1	13	53,5	90 Pcs	2,30 kg.
EM-70	70 mm²	11,5	14,7	57,5	65 Pcs	2,20 kg.
EM-95	95 mm²	13,5	16,7	61,5	50 Pcs	2,10 kg.
EM-120	120 mm²	15,6	19	74	40 Pcs	2,40 kg.
EM-150	150 mm²	16,5	21	79	25 Pcs	2,30 kg.
EM-185	185 mm²	18,4	23	85	22 Pcs	2,50 kg.
EM-240	240 mm²	21	26	94	18 Pcs	2,90 kg.
EM-300	300 mm²	23,4	28,6	98,5	10 Pcs	2,00 kg.
EM-400	400 mm²	26,8	32,8	112	-	-
EM-500	500 mm²	29,8	38,4	120	-	-
EM-600	600 mm²	34,5	44	140	-	-

* Our goods are Manufactured of electrolytic copper(E-Cu), they are full tempered, welded and min. 3 micron tin plated.

* Our company reserves the right of changing the dimension of the products without any prior notification.

DIN 46267 Type Butt-connectors



Features

- Tempering of the cable lugs during the production process provides ease of use of the Şafak Cable Lugs and more practical usage
- As the copper is been reheated at 700 degrees, it does not get broken after the crimping process.
- All of the Şafak Cable Lugs and Butt-connectors are being produced by tempering
- ⚠ You must crimp DIN 46267 Type Butt-connectors with DIN 46267 Type Dies

Material : EN 13600 standard copper
Surface : Tin Plated

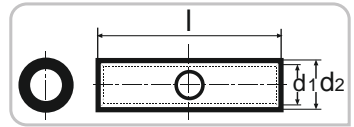

Product Code	Cross-Section mm ²	Dimensions (mm)			Package Amount	Package Weight (-kg)
		d1	d2	L		
EM-D2-010	10 mm²	4,5	6	30	300 Pcs	0,60 kg.
EM-D2-016	16 mm²	5,5	8,5	50	200 Pcs	2,80 kg.
EM-D2-025	25 mm²	7	10	50	150 Pcs	2,70 kg.
EM-D2-035	35 mm²	8,2	12,5	50	100 Pcs	3,00 kg.
EM-D2-050	50 mm²	10	14,5	56	60 Pcs	2,60 kg.
EM-D2-070	70 mm²	11,5	16,5	56	50 Pcs	2,69 kg.
EM-D2-095	95 mm²	13,5	19	70	30 Pcs	2,64 kg.
EM-D2-120	120 mm²	15,5	21	70	25 Pcs	2,44 kg.
EM-D2-150	150 mm²	17	23,5	80	20 Pcs	2,80 kg.
EM-D2-185	185 mm²	19	25,5	85	15 Pcs	2,52 kg.
EM-D2-240	240 mm²	21,5	29	90	10 Pcs	2,40 kg.
EM-D2-300	300 mm²	24,5	32	100	-	-
EM-D2-400	400 mm²	27,5	38,5	150	-	-
EM-D2-500	500 mm²	31	42	160	-	-
EM-D2-625	625 mm²	34,5	44	160	-	-

* Our goods are Manufactured of electrolytic copper(E-Cu), they are full tempered, welded and min. 3 micron tin plated.

* Our company reserves the right of changing the dimension of the products without any prior notification.